

Delivering professional-grade refrigeration solutions that your business depends on, combining reliability, efficiency, and innovation for the commercial refrigeration industry.

PROTECH CBC-1200WG

Commercial Merchandiser Refrigerator, Beverage Display Cooler



Commercial Refrigerator Merchandiser

12.2 cu. ft./345 L storage, this commercial merchandiser refrigerator is ideal for restaurants, cafes, convenience stores, gyms and more. With 8 adjustable shelves for unmatched flexibility.

Energy-Efficient LED Lighting & Customizable Light Box

Features LED lighting for enhanced product visibility and an attractive display. The lightbox is fully customizable to showcase your business name & customised graphics.

Commercial Applications

Double-paned tempered glass door provides excellent insulation and maintain internal temperatures. Safety lock with two keys for added security. Mobility wheels for easy transportation and flexible positioning.

Highest service standards

ETL and ETL-Sanitation (NSF 7) certified, guaranteeing safe operating temperatures and conditions.

Powerful Cooling

Features a low noise compressor and an internal air-cooling system for an evenly cool interior for perfectly chilled beverages. Set the internal temperature anywhere from high 50°F to low 32°F

PROTECH CBC-1200WG

Commercial Merchandiser Refrigerator, Beverage Display Cooler



Technical Specifications

External Dimensions	24.25" W x 24.75" D x 72.5" H
Internal Dimensions	21.0" W x 18.9" D x 49.8" H
Packaging Dimensions	26.5" W x 27.0" D x 75.5" H
Depth with Door Open 90°	49.9" D
Capacity	12.2 cu. ft./345 L
Cabinet Storage Capacity	336 standard 12 oz. cans
Net Weight	154 lbs
Gross Weight	171 lbs

Refrigeration Data

Temperature Range	32°F – 50°F
Refrigerant	R600a
Cooling System	No frost with fan
Control System	Mechanical

Construction Data

Exterior Material	Coated Steel
Cabinet Inner Wall Material	HIPS
Door	Gray door frame Transparent glass
Interior Light	1 LED light on the right wall
Shelves	8 adjustable wire shelves Shelf one: 56 cans Shelf two to eight: 245 cans Bottom: 35 cans
Portability Type	2 wheels + 2 legs

Electrical Data

Voltage/Frequency	115V /60Hz
Power	280 watts / 2.7 Amps
Plug Type	NEMA 5-15P
Electrical Cord Length	6 ft

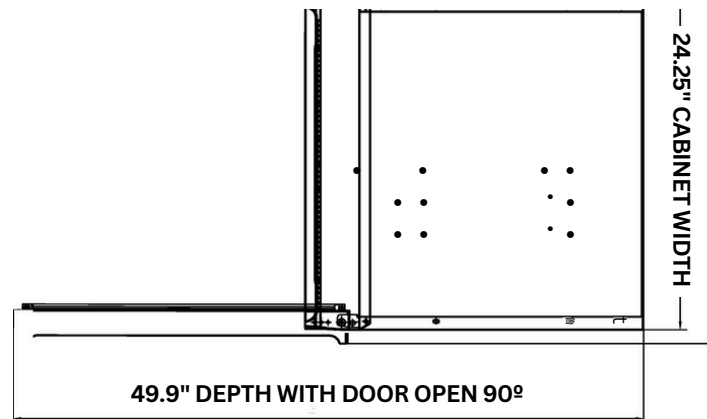
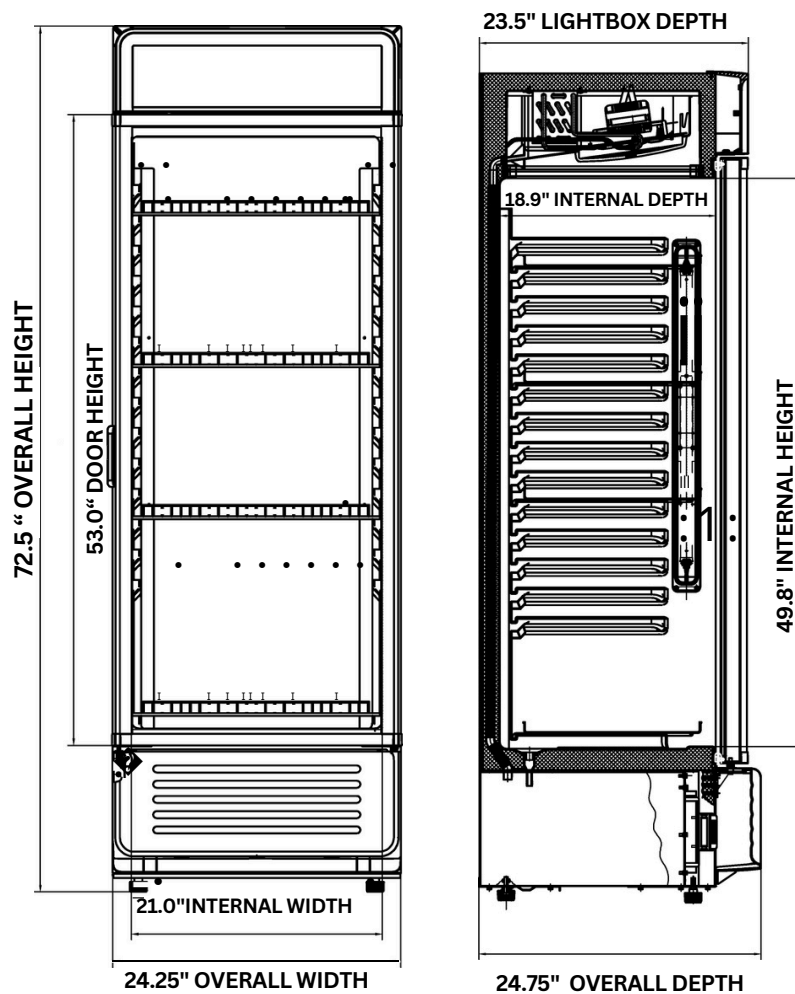

Specifications contained in this sheet are subject to change without notice.

